



Enter  
an Exclusive world

# THE NERUL WATERFRONT

At Nerul - Goa

A Project by





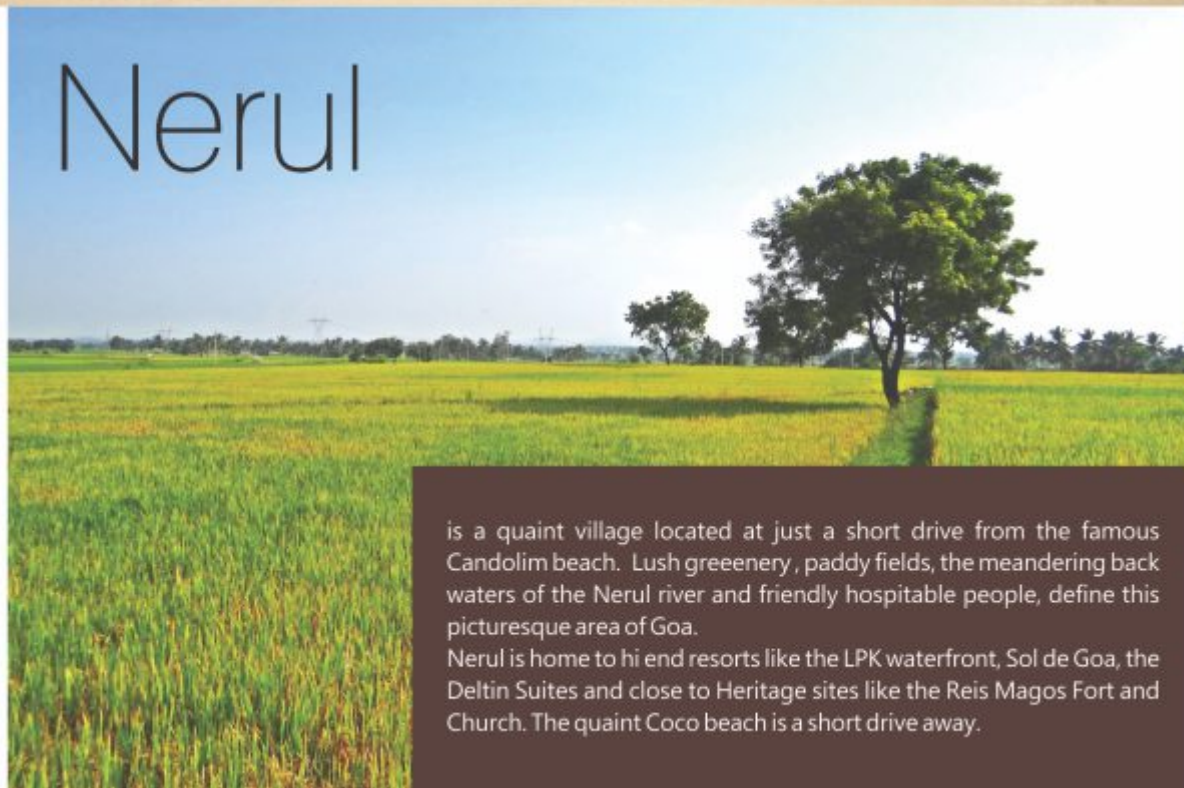



Naifer Constructions, a trusted name in construction, brings you their latest project, "The Nerul Waterfront", a purely residential scheme of 1 and 2 bedroom apartments.

Ideally located surrounded by lush greenery, the scheme is equipped with ultra modern amenities for luxurious living and to provide maximum comfort.

The Nerul Waterfront is the perfect gift for your family and a wise investment guaranteed to appreciate in the future!



Artist Impression



## Project Amenities

Swimming pool with deck area

Club house with indoor sports viz. Table Tennis, Carom, etc...

Landscaped Gardens with Sitting areas

Solar water heating in all Bathrooms and Kitchen

Gated Complex with round the clock security

Complete Back up power for common areas and UPS provision

24 hours Water Supply

Garbage management and disposal

Property management services



## Project Specifications

R.C.C Framed earthquake resistant structures.

230mm External and 120mm Internal Masonry walls.

Gypsum finish for internal walls.

Double coat External Plaster.

Powder coated aluminium sliding windows with 5mm clear glass.

All rust free plumbing.

High end quality Fixtures and Sanitary ware from Jaguar/ Kohler/ Hindware.

Vitrified flooring for entire apartments, with anti-skid floor for bath and designer wall dado in bathroom and Kitchen.

Designer Teakwood or equivalent main door and internal doors veneer finished.

Acrylic washable paint for interior surfaces.

Waterproof emulsion for external surfaces.

High quality, Maintenance free Galvalume sheet roofing over RCC Slabs.

Kitchens with drain board sink granite top finish.

High quality electricals using Anchor/ North – West/ Crabtree make wiring and switches.

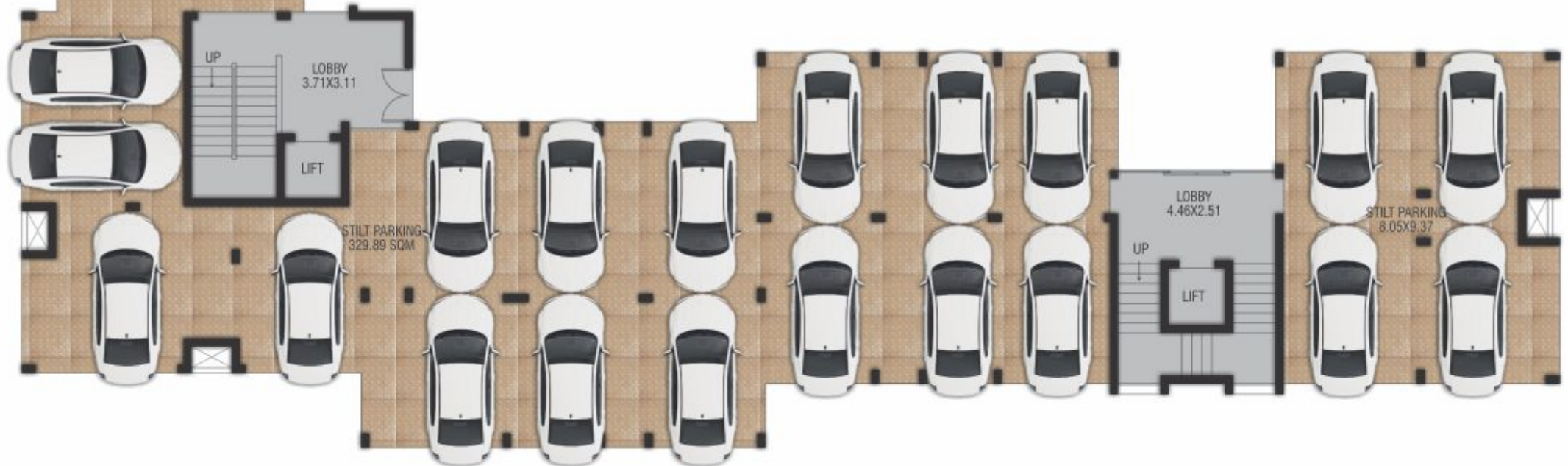
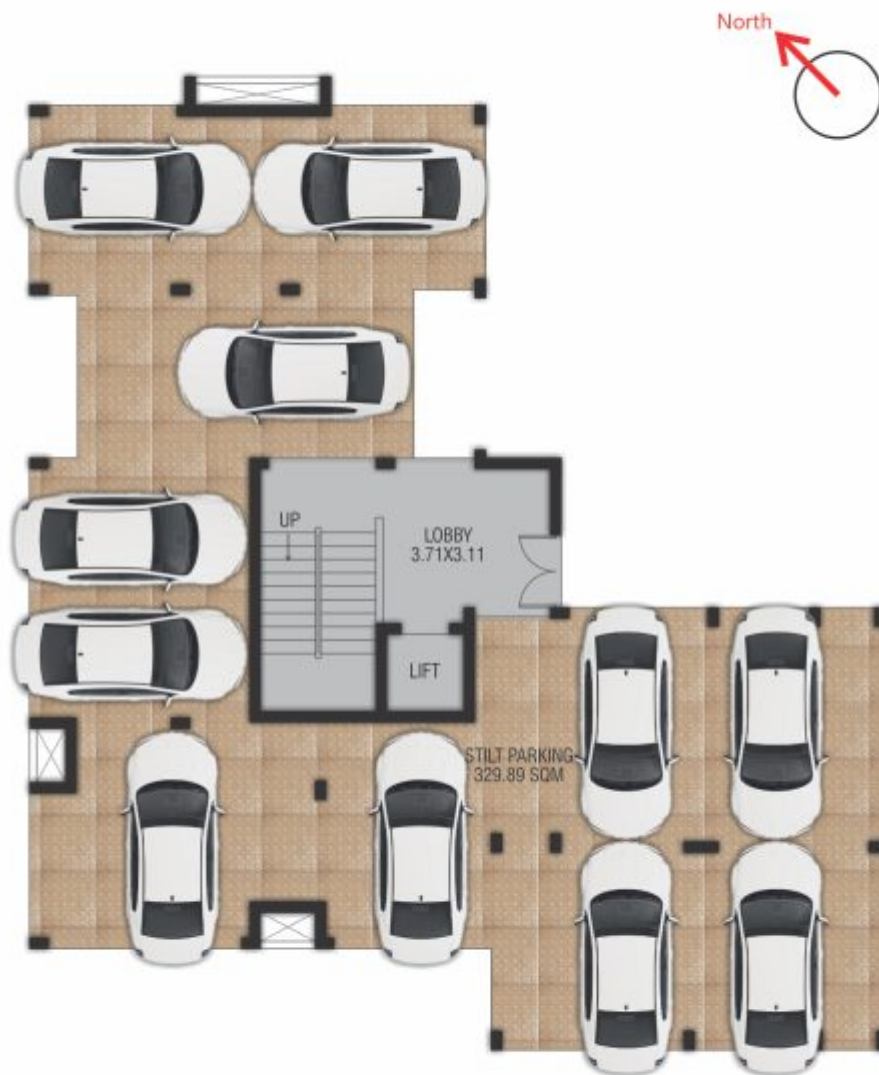

Stilt Floor Plan



101  
96.36 SQM



102  
110.58 SQM

103  
65.59 SQM

105  
71.11 SQM

106  
70.87 SQM

107  
118.21 SQM

104  
75.56 SQM



Upper Ground Floor Plan

201/301/401  
108.20 SQM

North



203/303/403  
65.59 SQM

205/305/405  
71.11 SQM



202/302/402  
110.58 SQM

204/304/404  
75.56 SQM

206/306/406  
70.87 SQM

207/307/407  
118.21 SQM

Typical First, Second and Third Floor Plan





For bookings & enquiries please contact



Milagre building, T.F-1,  
Morod Mapusa, Bardez - Goa  
Tel: +91 832 6452508  
E mail: [naiferconstructions@gmail.com](mailto:naiferconstructions@gmail.com)

Ashok Naik: +91 9960841270

Allan Fernandes: +91 9158403318 | +91 9890590318

Consultants :

Architect : Studio Archetype | RCC Consultant : Yogesh Bhobe

All Illustrations are artist impressions only.

The information contained in this brochure is subject to change and cannot form part of a legal offering or contract

